

Form Application for a premises licence

service_team_name Licensing Team

service_email_address licensing@midsussex.gov.uk

Your Details

Name/s: PAKEERATHAN SANMUGALINGAM

Premises

Postal address of premises or, if none, ordnance survey map reference or description:
ONE STOP
42-44 AMERICA LANE
HAYWARDS HEATH

Postcode RH16 3QB

Phone (at premises) 01282-500322

Email Email address redacted

Non-domestic rateable value of premises. £4301 - £33000

Plan of premises https://forms.midsussex.gov.uk/upload_dld.php?fileid=e1e990432d1d8965bd8eaa14f92f9b6d

Applicant type

Please state whether you are applying for a premises licence as: an individual or individuals

Applicant type

Please confirm: I am carrying on or proposing to carry on a business which involves the use of the premises for licensable activities

Individual Applicants

Title: (e.g. Mr/Mrs) MR

Name PAKEERATHAN SANMUGALINGAM

Address Address redacted

Postcode redacted

Phone phone number redacted

Email Email address redacted

Date of birth redacted

18 or over-I am 18 years old or over yes

Nationality SRI LANKAN

Is there a second individual applicant? No

Second Applicant

Other Applicants

Operating Schedule

When do you want the premises licence to start? 05/01/2023

If you wish the licence to be valid only for a limited period, when do you want it to end?

If 5,000 or more people are expected to attend the premises at any one time, please state the number expected to attend.

Description of premises

Description

The premises will be a new convenience store under the brand of ONE STOP where all types of convenience products will be sold including fresh & frozen food, toiletries, household, newspapers etc. Other services will also be offered to customers such as the ability to pay bills & collect/send packages. Alcohol will form approximately 15% of the goods on sale and as it is not the intended focus of the business there is an expectation that alcohol sales will have a limited impact on the area as local people are expected to on the whole purchase alcohol along with other products.

In terms of addressing the licensing objectives, this premises will be brand new and subject to significant investment which will involve the installation of high spec equipment such as CCTV, electronic refusals register and till prompts. In addition to that, in order to mitigate any risk from the sales of alcohol and its impact on the licensing objectives a number of robust conditions, which reflect the expected policies and procedures to be operated within the business, have been included as part of this application.

Licensable Activities

Plays

Will you be provisioning Plays? No

Monday

Tuesday

Wednesday

Thursday

Friday

Saturday

Sunday

Films

Will you be provisioning Films? No

Monday

Tuesday

Wednesday

Thursday

Friday

Saturday

Sunday

Indoor Sports

**Will you be provisioning
Indoor Sporting events?** No

Monday

Tuesday

Wednesday

Thursday

Friday

Saturday

Sunday

Boxing or wrestling

**Will you be provisioning
boxing or wrestling
events?** No

Monday

Tuesday

Wednesday

Thursday

Friday

Saturday

Sunday

Live Music

**Will you be provisioning
Live Music?** No

Monday

Tuesday

Wednesday

Thursday

Friday

Saturday

Sunday

Recorded Music

**Will you be provisioning
Recorded Music?** No

Monday

Tuesday

Wednesday

Thursday

Friday

Saturday

Sunday

Performances of dance

**Will you be provisioning
Performances of dance?** No

Monday

Tuesday

Wednesday

Thursday

Friday

Saturday

Sunday

Similar to live music, recorded music or performances of dance

**Will you be provisioning
anything with a similar
description to live music,
recorded music or
Performances of dance?** No

Monday

Tuesday

Wednesday

Thursday

Friday

Saturday

Sunday

Late Night Refreshment

**Will you be provisioning
any late night
refreshment?** No

Monday

Tuesday

Wednesday

Thursday

Friday

Saturday

Sunday

Supply of alcohol

Will you be provisioning any alcohol?	Yes
Monday	
Start Time	06:00
End Time	23:00
Tuesday	
Start Time	06:00
End Time	23:00
Wednesday	
Start Time	06:00
End Time	23:00
Thursday	
Start Time	06:00
End Time	23:00
Friday	
Start Time	06:00
End Time	23:00
Saturday	
Start Time	06:00
End Time	23:00
Sunday	
Start Time	06:00
End Time	23:00
Where will the supplied alcohol be consumed?	Off the premises
State any seasonal variations : For example (but not exclusively) where the supply of alcohol will occur on additional days during the summer months.	
Non standard timings. Where the premises intends to use the premises for the supply of alcohol at different times from those listed above, please list: For example (but not exclusively), where you wish the activity to go on longer on a particular day e.g. Christmas Eve.	
Premises Supervisor	
Name	PAKEERATHAN SANMUGALIGAM
Address	Address redacted
Postcode	redacted
Date of birth	redacted
Place of birth	SRI LANKA
Personal licence number (if known)	PA3222

Issuing licensing authority (if known) NORTHAMPTON BC

Opening Hours

Monday

Start Time 06:00

End Time 23:00

Tuesday

Start Time 06:00

End Time 23:00

Wednesday

Start Time 06:00

End Time 23:00

Thursday

Start Time 06:00

End Time 23:00

Friday

Start Time 06:00

End Time 23:00

Saturday

Start Time 06:00

End Time 23:00

Sunday

Start Time 06:00

End Time 23:00

State any seasonal variations : For example (but not exclusively) where the supply of alcohol will occur on additional days during the summer months.

Non standard timings. Where you intend to use the premises to be open at different times from those listed above, please list: For example (but not exclusively), where you wish the activity to go on longer on a particular day e.g. Christmas Eve.

Adult Entertainment

Please highlight any adult entertainment or services, activities, or other entertainment or matters ancillary to the use of the premises that may give rise to concern in respect of children. NONE

Licensing Objectives

General - all four licensing On first appointment, all staff employed at the premises will receive training on the

**objectives (b,c,d,e):
Please list here steps you
will take to promote all
four licensing objectives
together.**

Licensing Act 2003 including input on preventing underage sales, preventing sales of alcohol to people who are drunk and any other relevant matters. Training shall be regularly refreshed at no less than annual intervals. The training must be recorded and be accessible on the premises and made available for inspection upon request of a Police Officer or an authorised officer of the licensing authority or (in the case of online training) within 48 hours.

**The prevention of crime
and disorder:**

A CCTV system will be in operation at the premises and recorded images shall be retained for a period of 31 days. CCTV images will be provided to the police and other responsible authorities as soon as practicable and in any case within 48 hours of a request for such images, subject of the provisions of the DPA.

Public safety:

An incident register will be maintained at the premises and made available to the authorities on request.

**The prevention of public
nuisance:**

A register of refusals of alcohol will be maintained at the premises. The register will be made available for inspection by the Police and other responsible authority

**The protection of children
from harm:**

The premises will adopt a 'Challenge 25' policy. This means that if a customer purchasing alcohol appears to be under the age of 25, they will be asked for proof of their age, to prove that they are 18 years or older.
Posters will be on display advising customers of the 'Challenge 25' policy.
The only forms of identification that will be accepted will bear their photograph, date of birth and a holographic mark and/or ultraviolet feature. Examples of appropriate identification include a passport, photocard driving licence, military ID, and Home Office approved proof of age ID card bearing the PASS hologram.

Right to work

**I have included
documents
demonstrating my
entitlement to work in the
United Kingdom or my
share code issued by the
Home Office online right
to work checking service-Iyes
have included documents
demonstrating my
entitlement to work in the
United Kingdom or my
share code issued by the
Home Office online right
to work checking service**

**Please attach documents
demonstrating your
entitlement to work in the
United Kingdom.**

[https://forms.midsussex.gov.uk/upload_dld.php?
fileid=d9887006303630c6626a8c957cb10ae6](https://forms.midsussex.gov.uk/upload_dld.php?fileid=d9887006303630c6626a8c957cb10ae6)

Signatures

**I understand I am not
entitled to be issued with
a licence if I do not have
the entitlement to live and
work in the UK (or if I am
subject to a condition
preventing me from doing**

yes

work relating to the carrying on of a licensable activity) and that my licence will become invalid if I cease to be entitled to live and work in the UK (please read guidance note 15-I understand I am not entitled to be issued with a licence if I do not have the entitlement to live and work in the UK (or if I am subject to a condition preventing me from doing work relating to the carrying on of a licensable activity) and that my licence will become invalid if I cease to be entitled to live and work in the UK (please read guidance note 15

The DPS named in this application form is entitled to work in the UK (and is not subject to conditions preventing him or her from doing work relating to a licensable activity) and I have seen a copy of his or her proof of entitlement to work, or have conducted an online right to work check using the Home Office online right to work checking service which confirmed their right to work-The DPS named in this application form is entitled to work in the UK (and is not subject to conditions preventing him or her from doing work relating to a licensable activity) and I have seen a copy of his or her proof of entitlement to work, or have conducted an online right to work check using the Home Office online right to work checking service which confirmed their right to work

Date	07/12/2022
Please indicate your agreement by entering your name	Paul Sherratt
Capacity	AUTHORISED AGENT
Submit & Pay	
Address for correspondence associated with this application	LICENSING MATTERS 54 FAIRFIELD DRIVE CLITHEROE
Postcode	BB7 2PE
Phone	phone number redacted
Correspondence Email	Email address redacted
Confirm Email	Email address redacted
Payment Ref	1gjm0u53j

Amount to be paid: GBP 190

Order summary:

Item	Price	Total
Non-domestic rateable value of premises. - £4301 - £33000	£190.00	£190.00
TOTAL	£190.00	

The message has been sent from 90.212.1.155 (United Kingdom) at 2022-12-07 10:36:25 on Chrome 108.0.0.0
Entry ID: 43

please contact the one|stop design team for further information

existing shopfit plan

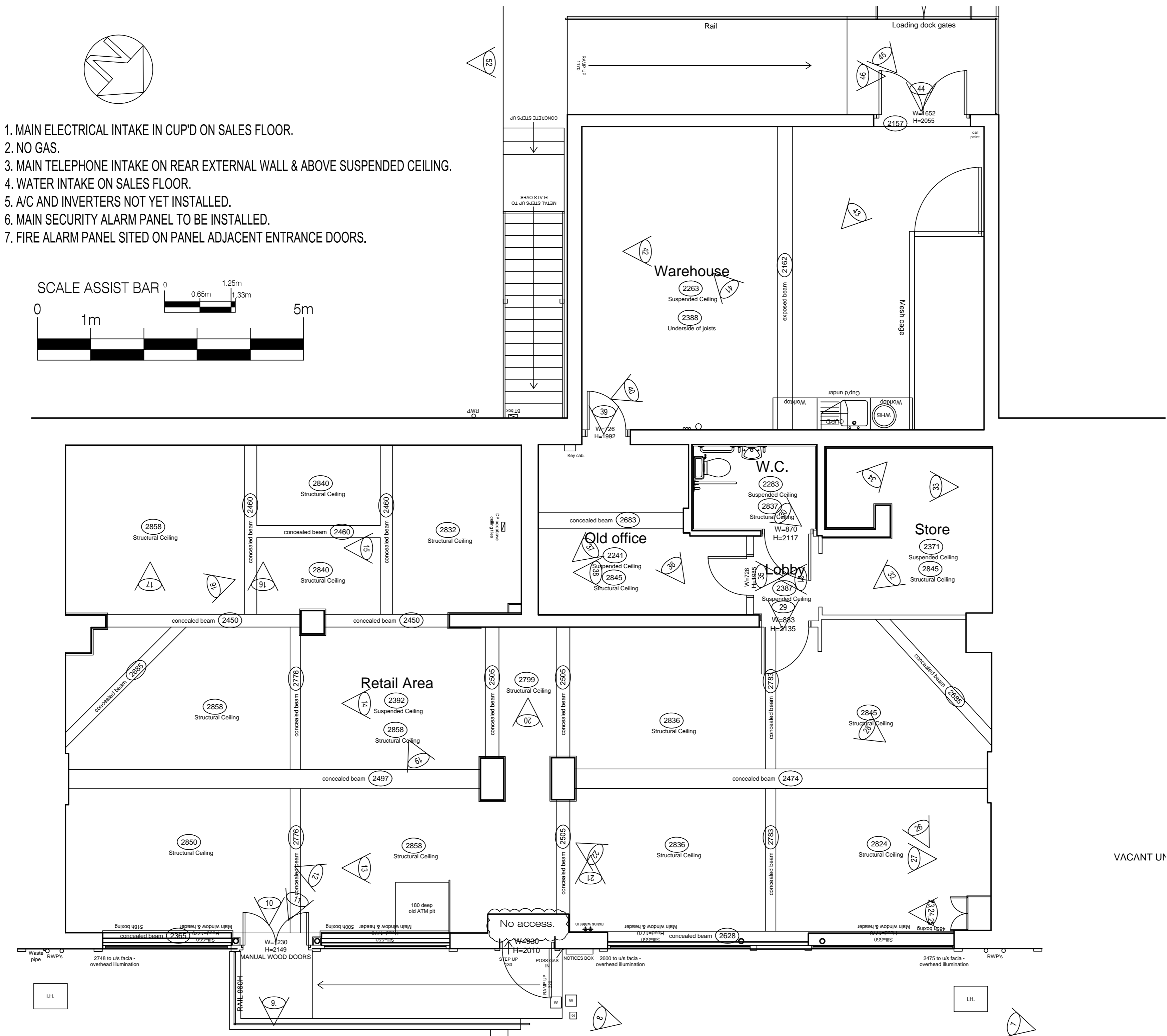

- chilled wine
- ambient wine
- wine wow
- chilled foods
- milk
- frozen foods
- take home ice cream
- ice cream impulse
- ambient produce
- bread
- cakes
- cereals
- dessert & spreads
- canned & packet
- ethnic
- savoury
- beverages
- biscuits
- vertical news
- magazines
- cards
- health & beauty
- babyware
- paperware
- household & laundry
- petfood
- countine confectionery
- hanging confectionery
- crisps & snacks
- adult snacks
- ambient soft drinks
- kids stop
- promo 1 - 4
- E1 bay
- grocery hot spot
- gantry
- spirit
- permanent stands
- stat (1m if req)
- indicate mods
- indicate sq12 (retail & boh)
- indicate banding

proposed shopfit plan

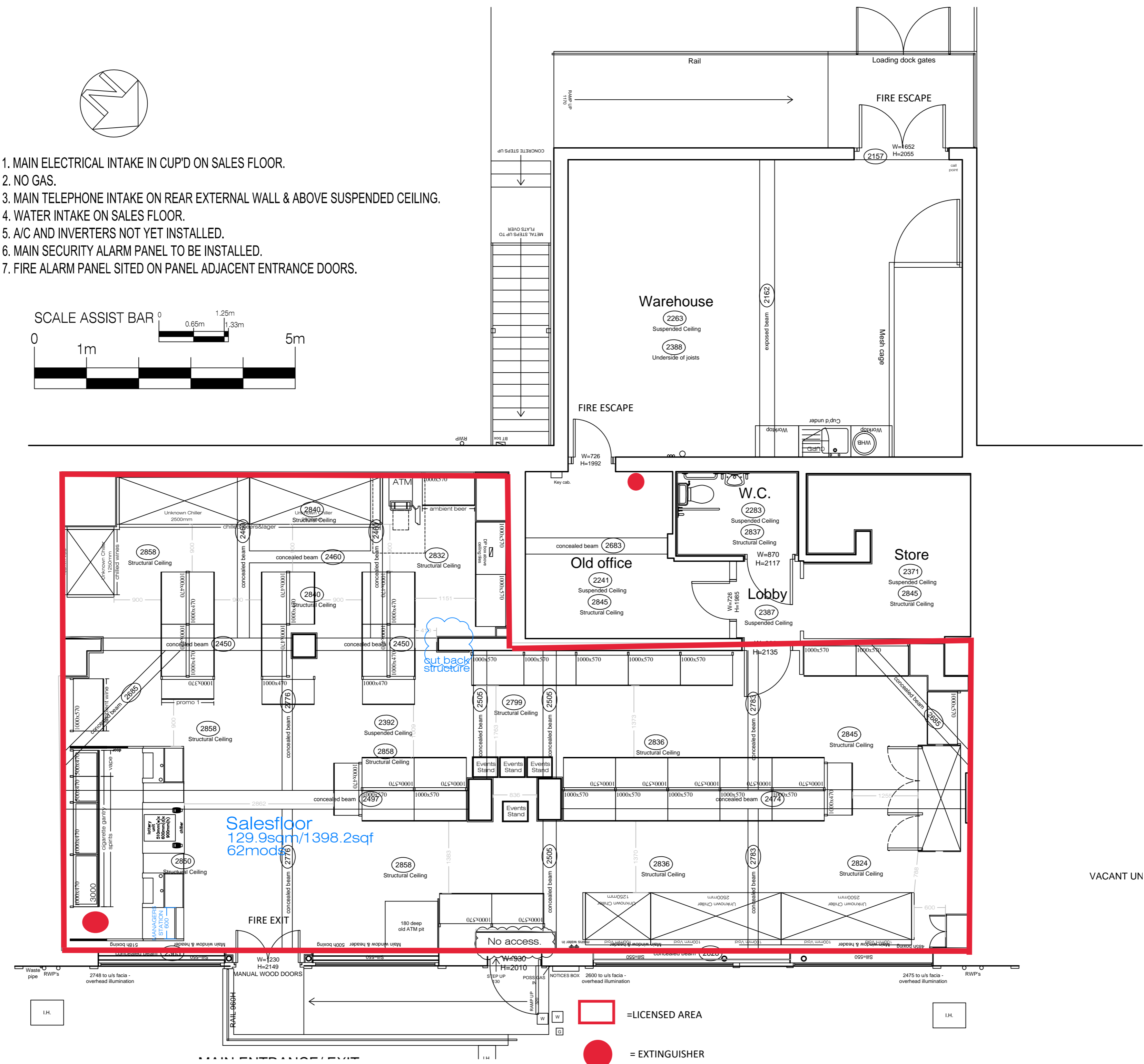

linear comparison:

Total	Existing	Target	Achieved

retailer approved

print name _____
 signed _____
 rev approved _____ date _____

stock room size

Small - Medium - Large

store profile:

old store grading:

Metal Stands - #

Combined: #

sales area: 128.62 m2

1,384 ft2

stock area: 52.53 m2

565 ft2

post office: 0 m2

0 ft2

project type:

franchise

store address:

42-48 AMERICA LANE,

HAYWARDS HEATH,

WEST SUSSEX.

RH16 3SX

store code: 6648

drawn by: Surveybase

date: 08-11-2022

scale: 1:50



SHOPFIT PLAN PROPOSED